

Technical Data Sheet

SO SET IN

PVC SKIRTING

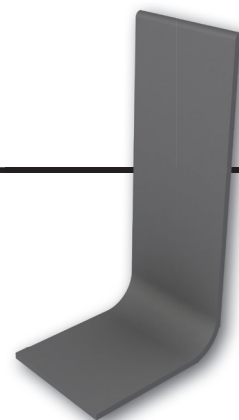

Description

SO SET IN is a 100mm high, flexible pvc ,set-in skirting/ coving, ideal for use with resilient floorcoverings in critical clean areas where a homogeneous finish is required e.g. hospital treatment areas.

Provides an impervious seal when welded to the floorcovering. Suitable for hot & cold welding.

Installation

SO SET IN skirting should be allowed to acclimatise for 24 hours prior to installation at an ambient temperature of 18° Celsius.

Set-in skirtings are installed prior to the floorcovering.

1. It should be ensured that all surfaces to which the profile is to be fixed are sound, dry, flat and free from any contaminants. Wall surfaces should be free from any previous coverings, linings or adhesive residues used to fix them. Paint films and any mould must be removed and the affected surface treated correctly.
2. Using a piece of skirting as a gauging template, place in position and use a pencil to mark the wall to provide a guideline for adhesive application.
3. All internal and external corners should be mitre cut.
4. Apply a suitable adhesive and follow the manufacturers instructions for application.
5. Bring both surfaces together and apply even pressure along the skirting ensuring any air bubbles are removed and full contact is made with the wall.
6. Vertical joints may be sealed using a mastic seal or PVC cold weld.

Technical Data			
Type:	Set In	Height	100mm
Environment:	Interior	Foot Depth:	50mm
Used with:	Resilient Floorcoverings	Gauge:	2mm
Material:	PVC	Thickness:	2mm
Colour:	Black (LRV: 4.62)	Length:	2.0m
Fixing:	Adhesive Fix	-	-

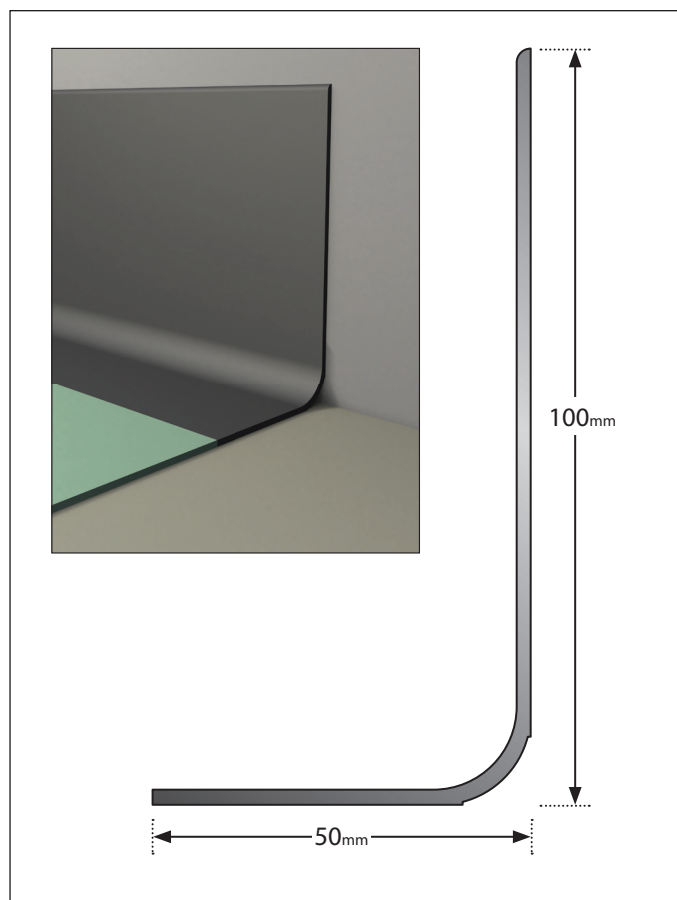

SO SET IN

PVC SKIRTING



Cleaning and maintenance guidelines:

These guidelines have been compiled to help the user obtain optimum performance and satisfaction from their selected product.

Preventative Maintenance Programme

- A regular scheduled maintenance programme should be employed to prevent the build up of dirt and grease, which will detract from the overall appearance of the product.

Daily Cleaning

- Brush down the profile using a soft bristled brush and remove dust particles from the profile by wiping with a damp cloth.

Twice Weekly or as Required

- Wipe the surface with a micro fiber cloth or mop, using the cleaning chemical at the correct dilution. Do not soak the profile.
Once the profile has been cleaned thoroughly rinse with fresh, clean water.

NB. Under no circumstances should chemicals containing citrus based agents, pine oils or hydrocarbons be used to clean SO SET IN skirting profile. Using bleach tablets will discolour the surface over time.

Steam cleaners, floor sealants, polishes or such coatings, should not under any circumstances, be applied to PVC skirtings or cappings.